

How to mount Pole Operated yoke

Once you have taken your projector, proceed with disassembling the standard yoke, unscrewing the screws on both sides (figure A).

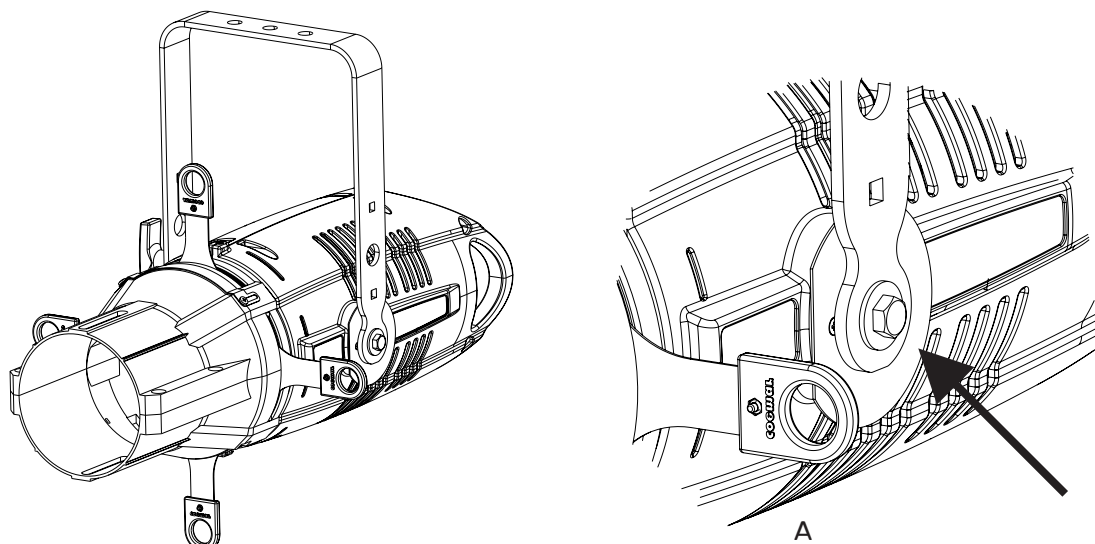

At this point, take the Pole Operated yoke and, after checking that the Pole Operated “drive boss” (figure B) is in line with the plate to which the yoke will be fixed, screw the two supplied screws (figure C).

