

# LEDko EXT FullSpectrum Dual Gobo Rotator +

Product code:  
F128T001A

Last update:  
04/10/2023



LEDko EXT FullSpectrum Dual Gobo Rotator

#### Introducing

● The **LEDko EXT family** has been designed to meet the needs of architects and lighting designers, who were looking for **weatherproof lighting fixtures** suitable not only for temporary, but also for **permanent outdoor installations**.

This unique IP 65 LED Profile Spot Light includes a **dual gobo rotator engine** controllable by DMX: in this way the two gobos can be used at the same time in counter-rotation to create impressive dynamic effects such as water, fire, rain, etc.

The **four-blade framing system** is however available as an accessory and can be used instead of the dual gobo rotator.

A **zoom lens** system ranging from 14° to 35°, 10° to 25°, 30° to 60° or fixed at 80°, bare ends power input cable and in/out 5 pin XLR connectors for DMX signal rated IP 65 complete the product profile. The fixture has in addition a **lockable display** thanks to a freely selectable security pin code.

Fixed white CCT (3.200 K or 5.600 K) and RGBLA color versions available.

#### Key Features



- Spot projector for dynamic lighting effects
- Dual gobo rotator engine controllable by DMX
- RGBLA color mixing (Red, Green, Blue, Lime, Amber)



- CCT Proportional control from 2.700 K → 6.500 K



- IP65 (weatherproof)
- For permanent outdoor installation



- Available zoom: 14°-35°, 10°-25°, 30°-60° and optic 80°



- Four blade framing system (optional accessory)



- Die-cast aluminum (Anti-Salt treatment)



- Custom color on request (optional)



- European Conformity certification

| General                               |  |
|---------------------------------------|--|
| ● LED Source                          | RGBLA LEDs module  |
| ● CCT Range                           | ●●●●● Proportional control from 2.700 K → 6.500 K  |
| ● Color Rendition Average             | CRI> 85  |
| ● Dimming                             | Smooth 100% to 0%, 5 Selectable Curves - Exponential, Logarithmic, Linear, Halo and Standard           |
| ● Dimming Smooth Selection            | Fast, Slow and Very Slow   |
| ● Strobe                              | Pulse electronic strobe  |
| ● Rotating gobo                       | Yes, two overlapping rotating gobos  |
| ● Lens                                | Zoom from 14° to 35° or from 10° to 25°, 30° to 60° and optic 80°                                      |
| ● Camera flicker control/Hz range     | Flicker-free operation with LEDs frequency controlled via DMX from 600 to 20.000 Hz                    |
| ● Calibrated Cob                      | Yes  |
| ● Electronics Type                    | Guaranteed flicker-free  |
| ● L80 Rating<br>(hours to 80% output) | 50.000 Hours   |
| ● Pattern Projection                  | Yes  |
| ● Pattern Size                        | A or B<br>Gobo outside diameter= 86 mm / 3.38 in<br>Max image diameter= 64.5 mm / 2.53 in              |
| Electrical                            |  |
| ● Voltage Input                       | 80-264 V, 50/60 Hz, auto-sensing   |
| ● Power Consumption                   | 285 W Maximum - 1.26 A at 230 V, 2.53 A at 115 V - cosφ 0.98   |
| ● Power Connection                    | Integral cable Bare Ends   |
| ● Data Connection                     | In/Out IP65 DMX Signal Junction Connector (Cod Art. RCN 73)  |
| Thermal                               |  |
| ● Ambient Operating Temperature       | -40° - +40°C (-40° - + 104° F)   |
| ● Fan (controllable)                  | Yes, 2 different settings: Silent and Auto   |
| Control                               |  |
| ● Protocols                           | DMX-512, RDM (Remote Device Management), Wireless (optional by LumenRadio)                             |
| ● RDM configuration                   | Yes  |
| ● DMX Channels                        | 19 / 10 / 4 / Studio mode / RGB mode   |
| ● Display                             | Graphic OLED   |
| ● Firmware upgrade                    | Through DMX with RDM Upgrade USB interface (code AC10011A001)  |
| Physical                              |  |
| ● Mounting                            | Yoke   |
| ● Materials                           | Die-cast aluminum (Anti-Salt treatment)  |
| ● IP Rating                           | IP65 (weatherproof)  |
| ● Color options                       | Black (standard), custom color on request (optional)   |
| Optics                                |  |
| BC10029A002                           | Profile Zoom 10°-25°   |
| BC10029A000                           | Profile Zoom 14°-35°   |
| BC10029A004                           | Profile Zoom 30°-60°   |
| BC10029A005                           | Lens Tube Profile 80°  |
| General accessories                   |  |
| BC10028A000                           | Four blade framing system (this accessory can be installed as an alternative to the dual gobo rotator) |
| BC10029A003                           | Frame Holder   |
| BC10029A100                           | LEDko EXT wireless kit   |
| BC016A010                             | Metal key for gobo mounting (included)   |
| RME34/G                               | DMX end of line closure cap (indispensable for the last projector of the line)                         |

|                          |                          |                        |                        |
|--------------------------|--------------------------|------------------------|------------------------|
| <b>19 Channels</b>       | <b>10 Channels</b>       | <b>RGB Mode</b>        | <b>Studio Mode</b>     |
| 01 → Master Dimmer       | 01 → Master Dimmer       | 01 → Master Dimmer     | 01 → Master Dimmer     |
| 02 → Red                 | 02 → Red                 | 02 → Dimmer Fine       | 02 → White Tone        |
| 03 → Green               | 03 → Green               | 03 → Red               | 03 → Green Saturation  |
| 04 → Blue                | 04 → Blue                | 04 → Green             | 04 → Saturation        |
| 05 → Spare Channel       | 05 → Spare Channel       | 05 → Blue              | 05 → Hue               |
| 06 → Lime                | 06 → Lime                | 06 → White Tone        | 06 → Dimmer Fine       |
| 07 → Amber               | 07 → Amber               | 07 → Saturation        | 07 → Special Functions |
| 08 → Strobe Effect       | 08 → Gobo Rotation Speed | 08 → Strobe Effect     |                        |
| 09 → Dimmer Fine         | 09 → Gobo 1 Speed        | 09 → Special Functions |                        |
| 10 → Special Functions   | 10 → Gobo 2 Speed        |                        |                        |
| 11 → Red Tone            |                          |                        |                        |
| 12 → Green Tone          |                          |                        |                        |
| 13 → Blue Tone           | <b>4 Channels</b>        |                        |                        |
| 14 → White Tone          | 01 → Master Dimmer       |                        |                        |
| 15 → Green Saturation    | 02 → Gobo Rotation Speed |                        |                        |
| 16 → Saturation          | 03 → Gobo 1 Speed        |                        |                        |
| 17 → Gobo Rotation Speed | 04 → Gobo 2 Speed        |                        |                        |
| 18 → Gobo 1 Speed        |                          |                        |                        |
| 19 → Gobo 2 Speed        |                          |                        |                        |

### LEDko EXT 80° Optic

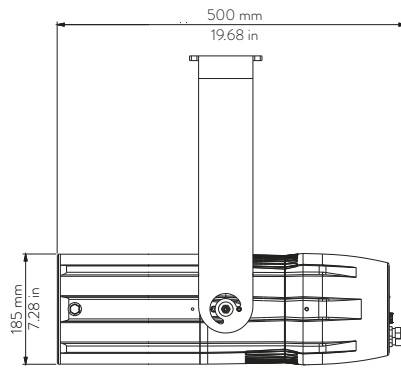
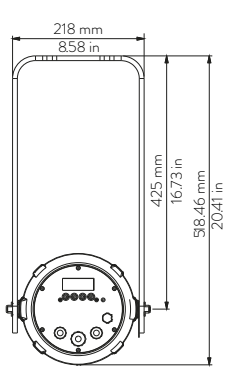

| Length             | Width               | Height            | Weight             |
|--------------------|---------------------|-------------------|--------------------|
| 500 mm<br>19.68 in | 252.6 mm<br>9.94 in | 185 mm<br>7.28 in | 12.1 Kg<br>26.6lbs |

With  
bracket:  
518.46 mm  
20.41 in

### LEDko EXT 30°-60° Zoom

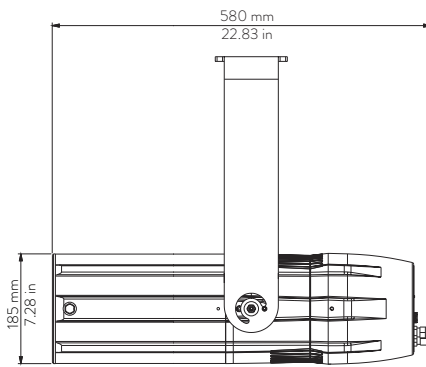
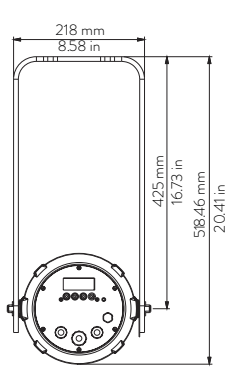

| Length             | Width               | Height            | Weight              |
|--------------------|---------------------|-------------------|---------------------|
| 580 mm<br>22.83 in | 252.6 mm<br>9.94 in | 185 mm<br>7.28 in | 12.6 Kg<br>27.7 lbs |

With  
bracket:  
518.46 mm  
20.41 in

### LEDko EXT 14°-35° Zoom

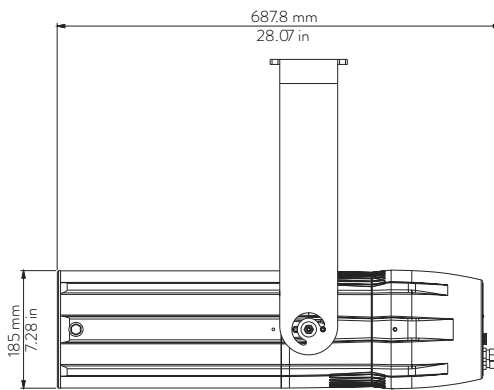
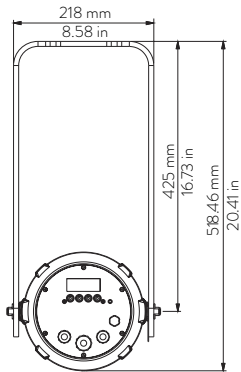

| Length               | Width               | Height            | Weight            |
|----------------------|---------------------|-------------------|-------------------|
| 687.8 mm<br>27.07 in | 252.6 mm<br>9.94 in | 185 mm<br>7.28 in | 14 Kg<br>30.8 lbs |

With  
bracket:  
518.46 mm  
20.41 in

### LEDko EXT 10°-25° Zoom

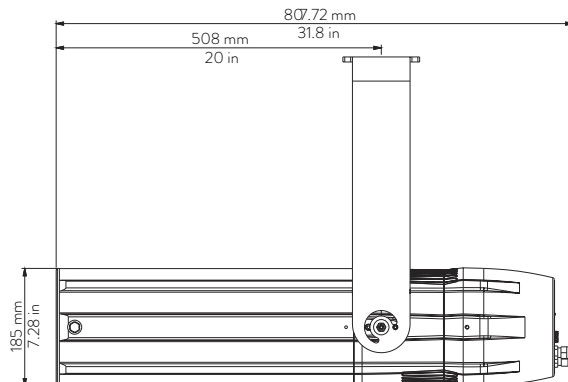
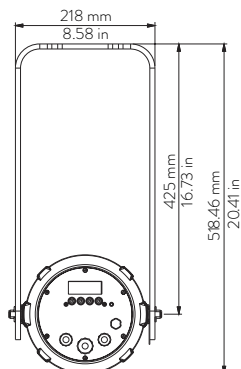

| Length              | Width               | Height            | Weight            |
|---------------------|---------------------|-------------------|-------------------|
| 807.2 mm<br>31.8 in | 252.6 mm<br>9.94 in | 185 mm<br>7.28 in | 15 Kg<br>33.1 lbs |

With  
bracket:  
518.46 mm  
20.41 in

Mounting yoke attachment point

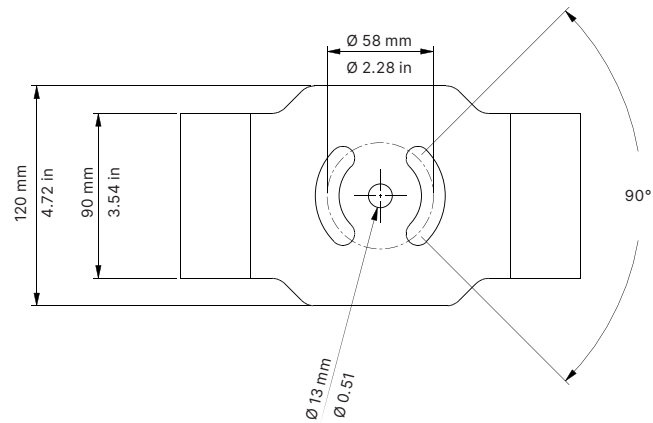

DMX Signal Junction Connector

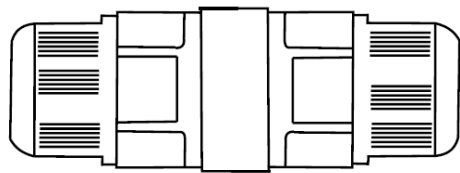

| Specification            |
|--------------------------|
| DMX 512 STANDARD:        |
| Pin 1 = Ground Wire      |
| Pin 2 = Negative (Black) |
| Pin 3 = Positive (White) |





House of Worship - Sheikh Zayed Grand Mosque Abu Dhabi

|                 |                                |
|-----------------|--------------------------------|
| Product         | LEDko EXT FS Dual Gobo Rotator |
| CCT             | RGBLA                          |
| CRI             | >85                            |
| Lighting design | Speirs Major                   |
| Installation    | Forza Electrical & Lighting    |





House of Worship - Sheikh Zayed Grand Mosque Abu Dhabi

|                 |                                |
|-----------------|--------------------------------|
| Product         | LEDko EXT FS Dual Gobo Rotator |
| CCT             | RGBLA                          |
| CRI             | >85                            |
| Lighting design | Speirs Major                   |
| Installation    | Forza Electrical & Lighting    |





House of Worship - Sheikh Zayed Grand Mosque Abu Dhabi

|                 |                                |
|-----------------|--------------------------------|
| Product         | LEDko EXT FS Dual Gobo Rotator |
| CCT             | RGBLA                          |
| CRI             | >85                            |
| Lighting design | Speirs Major                   |
| Installation    | Forza Electrical & Lighting    |

● Coemar Lighting S.r.l.

Via Carpenedolo, 90  
46043, Castiglione delle Stiviere (MN) – Italy

P. +39 0376 1514412  
M1. [info@coemar.com](mailto:info@coemar.com)  
M2. [service@coemar.com](mailto:service@coemar.com)  
W. [coemar.com](http://coemar.com)

P.iva – C.f. 02415330204

