



Phantom FullSpectrum 6

Product code: F036Q000P

KEY FEATURES

- Color mixing through 6 colors: Red, Green, Blue, Cyan, Lime, Amber
- 2700 K - 7500 K Continuously Variable Correlated Color Temperature with color rendering index greater than 90 (CRI Average > 95)
- Motorized zoom range from 14° to 84°
- Green-Magenta Adjustment
- Flicker-free operations with LEDs frequency controlled via DMX from 600 Hz to 19000 Hz
- PowerCon In/Out
- Fan setting with 4 different options (low, auto, studio, DMX regulated)



SPECIFICATIONS

- Red, Green, Blue, Cyan, Lime, Amber color mixing
- CCT: all whites from 2700 to 7500 K
- Fresnel lens (diameter: 200 mm / 7.87 in)
- Motorized zoom range from 14° to 84°
- Electronic 16 bit dimming with 3 selectable curves (exponential, logarithmic, linear)
- Synchronized, random or pulse electronic strobe
- Flicker-free operation with LEDs frequency controlled via DMX from 600 Hz to 19000 Hz
- Fan setting with 4 different options (low, auto, studio, DMX regulated)
- Weatherproof rating IP 20

LIGHT SOURCE

- Modular multiple LEDs, CRI Average > 95
- LEDs life: 20.000 hours at 70% lumen intensity maintenance

PHYSICAL SIZE

- Length: 579 mm (22.8 in)
- Width: 325 mm (12.79 in)
- Height: 318 mm (12.5 in)
- Height, with bracket: 458 mm (18.03 in)
- Weight: 13.5 Kg (29.8 lbs)

CONTROL PROTOCOL AND PROGRAMMING

- USITT DMX512A
- DMX Channels: 18/9/7/3
- Setting, addressing, testing and measurements via LEDs display
- Remote Device Management (RDM)

ELECTRICAL SPECIFICATIONS AND CONNECTIONS

- AC power: 90-230 V, auto sensing, 50/60 Hz
- Max power consumption: 330 W
- Power consumption: 1.44 A at 230 V, 3.70 A at 90 V - cosφ 0.99
- In and Out PowerCon connectors
- DMX data in/out: 5 pin locking XLR

ACCESSORIES

- Pole operated yoke
- 4-leaf barndoor
- Color frame holder

DRAWING SIZE

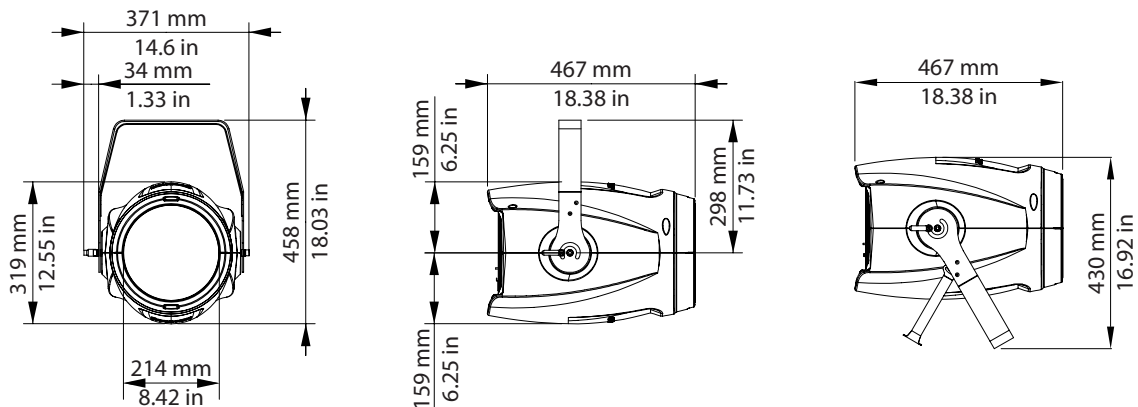

DMX CHARTS

18 channels	
1	master dimmer
2	red
3	green
4	blue
5	cyan
6	lime
7	amber
8	strobe effect
9	dimmer fine
10	special function
11	red tone
12	green tone
13	blue tone
14	white tone
15	green saturation
16	saturation
17	zoom
18	motor reset

9 channels	
1	master dimmer
2	red
3	green
4	blue
5	cyan
6	lime
7	amber
8	zoom
9	motor reset

7 channels	
1	master dimmer
2	white tone
3	green saturation
4	dimmer fine
5	special function
6	zoom
7	motor reset

3 channel	
1	master dimmer (color temperature settable by display)
2	zoom
3	motor reset