

# MiniLEDko Spot

Last update:  
25/10/2023



## MiniLEDko Spot

### Introducing

● We took our flagship product and made it smaller. Much smaller. We are proud to introduce you to the new Coemar product family, MiniLEDko.

Thanks to MiniLEDko we can expand our offer and make available all the quality we offer with LEDko, in a much smaller body. High power is not always necessary and this is why MiniLEDko was born. Anyone who needs a profiler with an incredible light emitted/power ratio must have our brand new MiniLEDko. We have thought of everything, from optics to mounting options, to communication protocols, to ensure that anyone can find the perfect product for their needs.

### Configuration

● MiniLEDko are available in three different mounting options to fit any installation

1. Portable
2. Canopy
3. Track

### Key Features



- 25 W White COB LED (T/D version)
- 35 W COB LED (VW version)



- High CRI > 95



- CCT Fixed White: 2.700 K, 3.000 K, 4.000 K or 5.600 K
- CCT VariWhite: from 2.700 K → 6.500 K



- IP 20 or 65



- High Definition Optics
- High lumen flux and flat field



- Swappable optics from 16 to 27°



- Full Body in Aluminum



- Custom color on request (optional)



- Track, Portable, Canopy

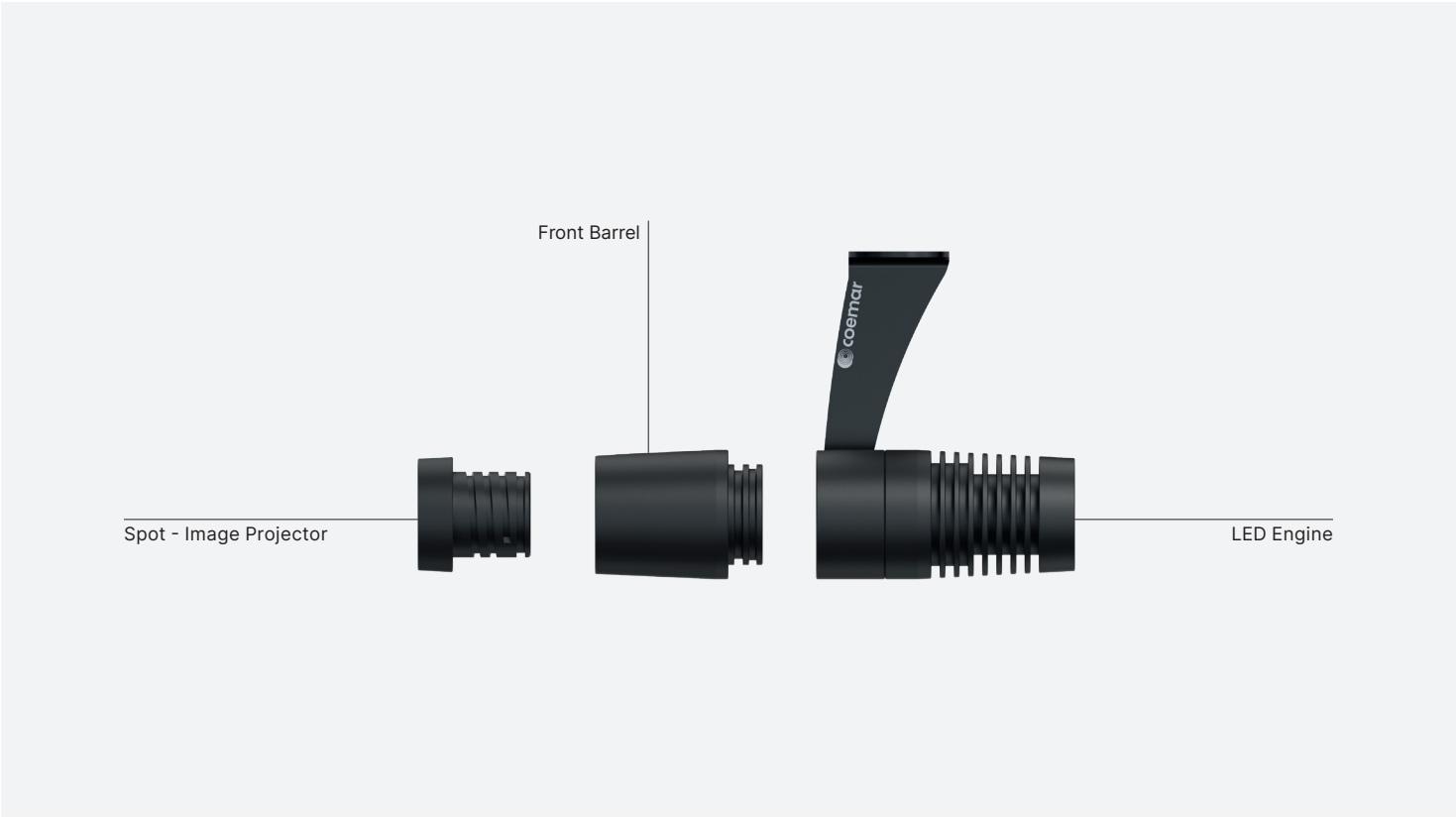

MiniLEDko Spot - Versions

Versions

Family	Version	Optic	Barrel	Mounting	Controls
MiniLEDko	Spot	Lens 16°	Integrated Barrel	Portable	DMX512
		Lens 22°		Track	DALI
		Lens 27°		Canopy	On / Off
					On Board Potentiometer
					Bluetooth App

General	
● LED Source	25 W White COB LED (T/D version), 35 W COB LED (VW version), 40 W COB LED (RGBW, soon available)
● CCT Range	<span style="color: orange;">●</span> <span style="color: yellow;">●</span> <span style="color: lightblue;">●</span> 3.000 K, 5.600K (On request available 2.700 K, 3.500 K, 4.000 K, 5.000 K, 6.500 K) <span style="color: orange;">●</span> <span style="color: yellow;">●</span> <span style="color: lightblue;">●</span> 2.700K → 6.500K (VariWhite Version) <span style="color: orange;">●</span> <span style="color: yellow;">●</span> <span style="color: lightblue;">●</span> 2.700K → 6.500K (RGBW version, soon available)
● Color Rendition Average	CRI> 96 (96 @3200 K, 97 @5600 K) TLCI >98 (98 @3200 K, 99 @5600 K) CRI >93 TLCI >95 (VariWhite version)
● Available Optics	Lens 16° / 22° / 27°
● L80 Rating (hours to 80% output)	50.000 Hours
● Pattern projection	Yes (internal gobo holder)
● Pattern Size	Gobo outside diameter= 26 mm / 1.02 in Max image diameter= 22 mm / 0.86 in Max Gobo thickness= 2mm / 0.08 in (glass gobo)
Electrical	
● Voltage Input	100-240 V, 50/60 Hz (on request available other voltage range)
● Power Consumption	20 W Typical - 0.07 A at 230 V, 0.15 A at 115 V - cosφ: 0.9
● Power Connection	1.5 m (4.92 ft) integrated cable without power plug (canopy and portable version)
Thermal	
● Ambient Operating Temperature	0°C - +40°C (32°F - 104°F)
● Cooling	Passive cooling and fan-free
Control	
● Protocols	On/Off, On board potentiometer, Dali, Bluetooth App , DMX, Wireless (optional)
● RDM	DMX Setup, Fixture Status, RDM Commands (only DMX version)
Physical	
● Yoke	Track, Canopy, Portable (Hook with M10 Thread)
● Materials	Aluminum construction (EN AB-46100 grade)
● Fine Texture	High temperature powder-coated paint
● Tool-free	Tilt and beam adjustment
● Gobo pattern holder	26 mm with a 22 mm image area (included)
● Weight	1.5 Kg / 3.31 lbs
● Length	212 mm / 8.35 in
● Height	64 mm / 2.51 in - With bracket: 162 mm / 6.38 in
● Width	79.5 mm / 3.13 in
● IP Rating	IP20 or 65 (only portable version)
● Color options	Black (standard), custom color on request (optional)
Optics	
BC016A000	Lens 16°
BC016A001	Lens 22°
BC016A002	Lens 27°
General accessories	
BC016A100	Front Barrel for Lens 16° and 22°
BC016A110	Front Barrel for Lens 27°
BC016A010	Metal key for gobo mounting (included)
BC015A300	Track adapter for surface or clamp fixing (for track version T/D - clamp not included)

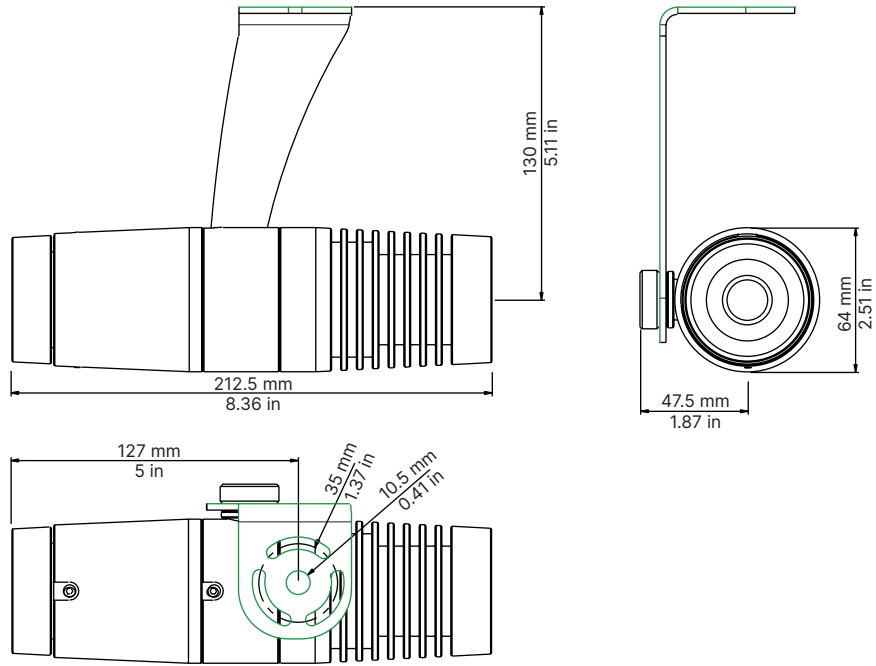

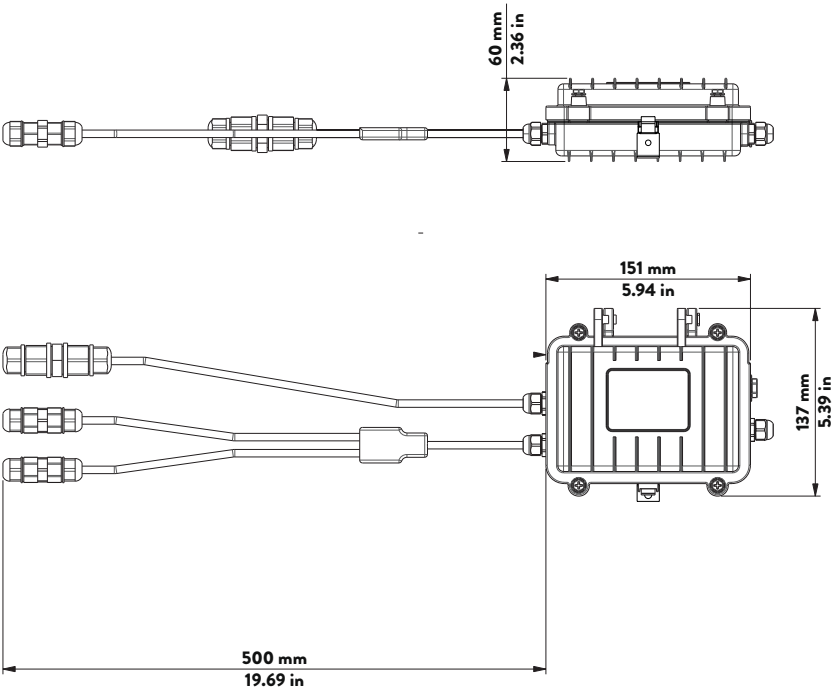

\*Power Box

Models

MiniLEDko family		LED source		Color		Mounting Options		IP		Control	
Image projector	F116	T (CRI>95)	A	Black	0	None	A	IP20	0	None	A
		D (CRI>95)	B	Silver	1	Track	B	IP65	1	DMX Control	B
		VariWhite	G	White	2	Portable	C			DALI Control	C
				Custom	X	Canopy	D			Bluetooth App Control	D
										On Board Potentiometer Control	E
										On-Off Control	F

DALI, DMX versions - Table A

Manufacturer	Type	Model	System
Nordic Aluminium	Global Track pulse DALI	XTSC 6x00 XTSCF 6x00 x=1, 2, 3, 4	3-phase + SIGNAL
Stucchi	Three-Phase Track + Control System	9000-.../...-ST 9000-.../...-R	3-phase + SIGNAL
Powergear	3 Circuits DALI track system	PRO-06X0, 064000 PRO-R6x0, R6400 x=1, 2, 3	3-phase + SIGNAL
Eutrac	One Track	575 2 1101 575 2 1102 575 2 1103 575 2 1104	3-phase + SIGNAL

On/Off, On board potentiometer, Bluetooth App versions - Table B \*

Manufacturer	Type	Model	System
Nordic Aluminium	Global Track Pro	XTS 4x000 x= 1, 2, 3, 4	3-phase
Eutrac	Surface Track	25-x0 x= 1, 2, 3, 4	3-phase
Zumtobel	3 Circuits DALI track system	S2 801 S2 803	3-phase
Ivela	3-phase LKM	7501-x0 x= 1, 2, 3, 4	3-phase
Powergear	3 Circuit Track system	PRO-04x0 x= 1, 2, 3	3-phase

\* On/Off, On board potentiometer, Bluetooth App versions products can also be switched on and powered by the tracks indicated in table A, but obviously they cannot be controlled or dimmed via a control signal





Exhibition - PLS Frankfurt Germany

Product	MiniLEDko Spot D
CCT	5.600K
CRI	>95





Exhibition - PLS Frankfurt Germany

Product	MiniLEDko Spot D
CCT	5.600K
CRI	>95

## Mini LEDko Spot Tungsten

Optic: **Lens 16°**

Distance(m)	1	2	3	4	5	6	7	8	9	10
lux	4797	1199	533	300	192	133	98	75	59	48
Diameter Ø (m)	0.28	0.56	0.84	1.12	1.41	1.69	1.97	2.25	2.53	2.81

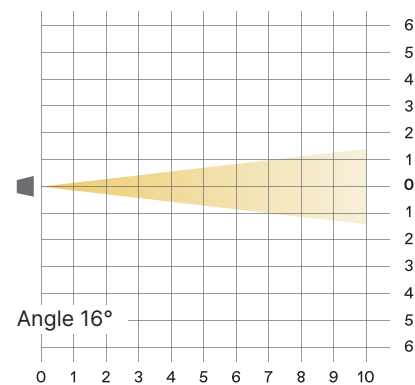

Optic: **Lens 22°**

Distance(m)	1	2	3	4	5	6	7	8	9	10
lux	2484	621	276	155	99	69	51	39	31	25
Diameter Ø (m)	0.39	0.78	1.17	1.56	1.94	2.33	2.71	3.11	3.50	3.89

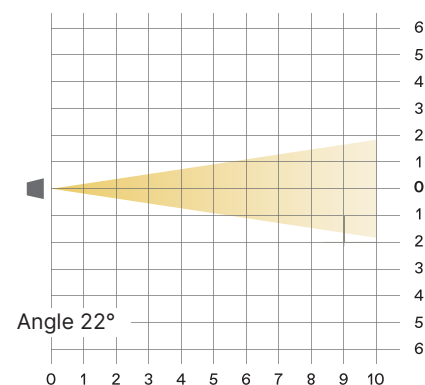

Optic: **Lens 27°**

Distance(m)	1	2	3	4	5	6	7	8	9	10
lux	1809	452	201	113	72	50	37	28	22	18
Diameter Ø (m)	0.48	0.96	1.44	1.92	2.40	2.88	3.36	3.84	4.32	4.80

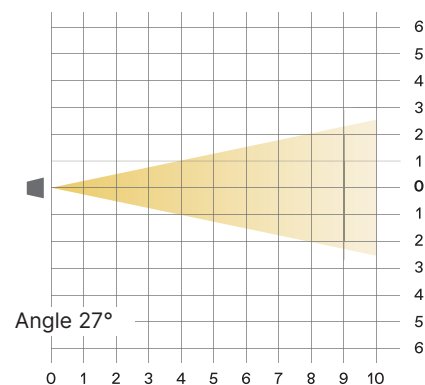

● Coemar Lighting S.r.l.

Via Carpenedolo, 90  
46043, Castiglione delle Stiviere (MN) – Italy

P. +39 0376 1514412  
M1. [info@coemar.com](mailto:info@coemar.com)  
M2. [service@coemar.com](mailto:service@coemar.com)  
W. [coemar.com](http://coemar.com)

P.iva – C.f. 02415330204

